

GE  
Lighting

# Tetra<sup>®</sup> miniStrip

LED Lighting System

The perfect fit for *shallow* cabinet signs.



GE imagination at work

# Tetra® miniStrip & Tetra® miniStrip DS

Remarkable performance plus reduced installation costs

New Tetra miniStrip and miniStrip DS are designed specifically for shallow box signs.

Tetra miniStrip is ideal for single-sided signs with a 3 to 6 inch can depth, while Tetra miniStrip DS is perfect for double-sided signs with a 6 to 12 inch can depth.

Tetra miniStrip produces money-saving advantages over T8 fluorescent tubes while delivering outstanding visual performance that protects end-user brand image.

Transform your shallow cabinet signs into better looking, better performing images for your business with new Tetra miniStrip and miniStrip DS.

## Enhance your brand image with the superior, even look of LED.

Tetra miniStrip uses GE's patented lens technology, OptiLens™ which captures otherwise wasted light and redirects it towards the illuminated surface to create an exceptionally uniform sign.

Tetra miniStrip

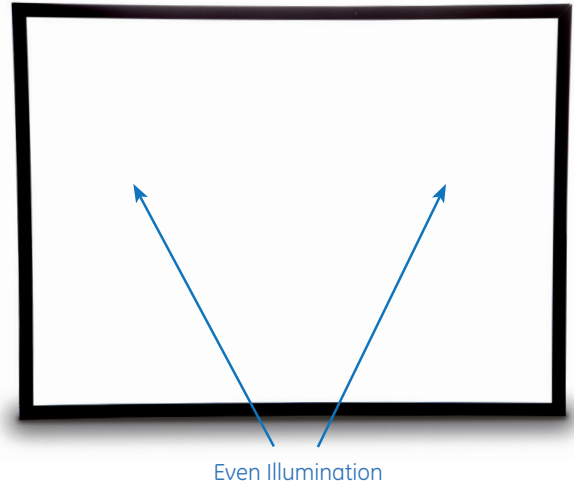

T8 fluorescent tubes can create an unwanted "striping" effect where the space between the tubes appears darker. This visual distraction sends the wrong message about your business, and undermines your overall brand image.

Fluorescent T8

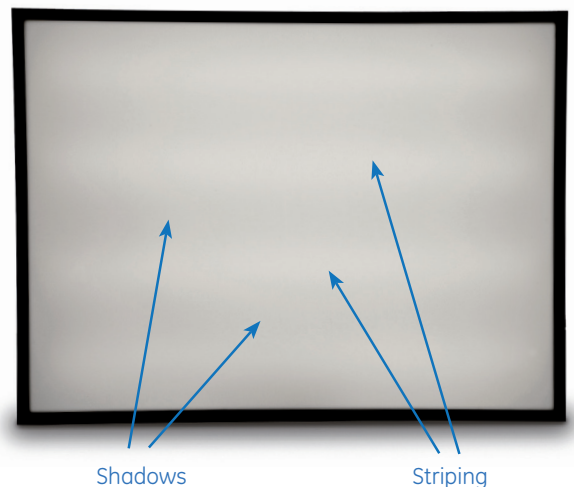

When brightness matters most, **Tetra miniStrip High Output** and **Tetra miniStrip DS High Output** deliver even more bright uniform light across the entire sign face, commanding attention to your brand image.



# Don't settle for the *performance limitations* of T8 Fluorescent tubes.

## Cold weather concerns.

A T8 fluorescent sign can drop in brightness as the temperature decreases. The LED technology in Tetra miniStrip experiences no drop in performance under the same conditions, protecting the integrity of your brand.

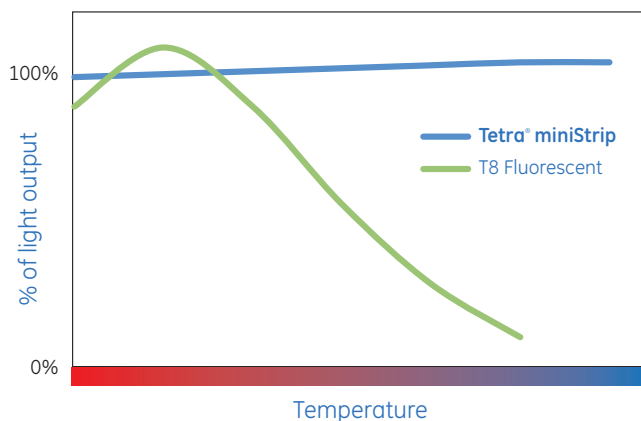

## Impressive Energy Savings.

When you make the switch from T8 fluorescent tubes to the advanced technology of Tetra miniStrip, you give up some brightness for the exceptional uniformity and impressive energy savings of LED. Versus T8, Tetra miniStrip saves up to 90% and with Tetra miniStrip DS the savings is up to 79%. Imagine the positive impact that will have on your bottom-line over the long life of the system.

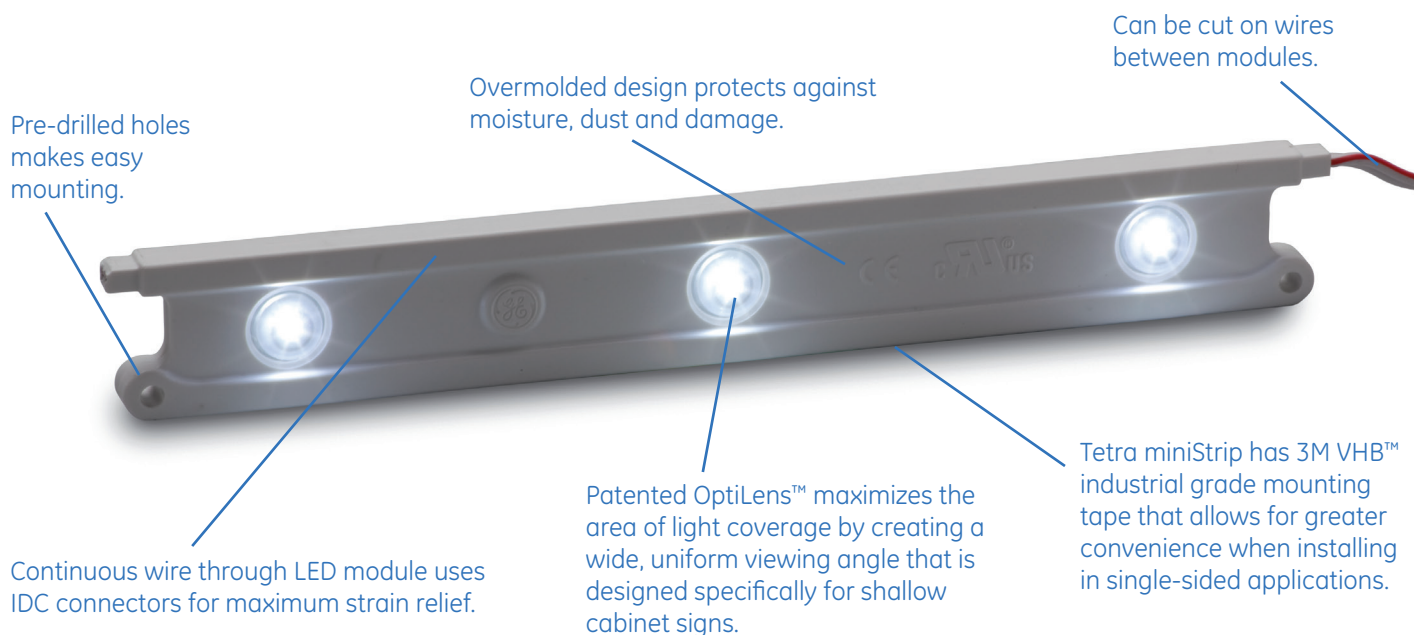
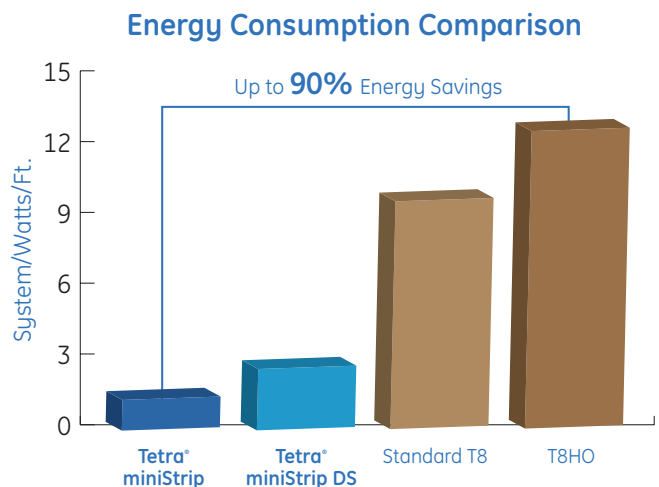

## Components

Product Code	SKU	Description	EEC	Energy consumption [kWh/1000h]	Package Quantity
GEWHBSP3WD	98644	Tetra miniStrip 7100K	A++	1.21	48 Modules
GEWWBSP3-50K	98578	Tetra miniStrip 5000K	A++	1.21	48 Modules
GEWWBSP3-41K	98577	Tetra miniStrip 4100K	A++	1.21	48 Modules
GEWWBSP3	98576	Tetra miniStrip 3200K	A++	1.21	48 Modules
GEWHBDP6	98579	Tetra miniStrip DS 7100K	A++	2.42	32 Modules
GEWWBDP6-50K	98582	Tetra miniStrip DS 5000K	A++	2.42	32 Modules
GEWWBDP6-41K	98581	Tetra miniStrip DS 4100K	A+	2.42	32 Modules
GEWWBDP6	98580	Tetra miniStrip DS 3200K	A+	2.42	32 Modules
GEBSH71-1	98950	Tetra miniStrip High Output 7100K	A++	1.64	48 Modules
GEBSH50-1	98951	Tetra miniStrip High Output 5000K	A++	1.64	48 Modules
GEBSH41-1	98952	Tetra miniStrip High Output 4100K	A+	1.64	48 Modules
GEBSH32-1	98953	Tetra miniStrip High Output 3200K	A+	1.64	48 Modules
GEBDH71-1	98954	Tetra miniStrip DS High Output 7100K	A+	3.28	32 Modules
GEBDH50-1	98955	Tetra miniStrip DS High Output 5000K	A+	3.28	32 Modules
GEBDH41-1	98956	Tetra miniStrip DS High Output 4100K	A+	3.28	32 Modules
GEBDH32-1	98957	Tetra miniStrip DS High Output 3200K	A+	3.28	32 Modules
9409	68347	18 AWG Supply Wire (0.82 mm <sup>2</sup> )	-	-	500 ft./spool (152.4 m)
191600041	98509	22-14 AWG Twist-On Wire Connectors (0.33 – 2.08 mm <sup>2</sup> )	-	-	500/PK
192160004	98524	18-14 AWG In-line Connectors (IDC) (0.82 – 2.08 mm <sup>2</sup> )	-	-	500/PK
GEDSRL08	98526	Tetra Mounting Rail	-	-	8 Rails
GEDSLB1	98525	Tetra Mounting Rail Assembly Bracket	-	-	20/PK

## Technical Specifications

Specification Item	Wavelength	Typical Brightness (lumens/module)	LEDs/Module	Energy Consumption (Strip/Module)	Energy Consumption (System/Module)	Power Supply Loading	Viewing Angle
Tetra miniStrip	7100K, 5000K 4100K, 3200K	96 72	3	1.10	1.32	53 Modules / 60W PS	140°
Tetra miniStrip DS	7100K, 5000K 4100K, 3200K	192 144	6	2.20	2.64	39 Modules / 100W PS	140°
Tetra miniStrip High Output	7100K, 5000K 4100K, 3200K	125 94	3	1.44	1.60	42 Modules / 60W PS	140°
Tetra miniStrip DS High Output	7100K, 5000K 4100K, 3200K	250 188	6	2.88	3.20	30 Modules / 100W PS	140°

Specification Item	Tetra miniStrip
Cutting Resolution	Cut on wire between every module
Power Supply	GEPS12-20 Input: 90-264VAC; Output: 12VDC (98612)    GEPS24-20 Input: 90-264VAC; Output: 24VDC (98603) GEPS12-60-GL Input: 108-305VAC; Output: 12VDC(98917)    GEPS24W-80 Input: 90-264VAC; Output: 24VDC (98606) GEPS12W-60 Input: 90-264VAC; Output: 12VDC (98616)    GEPS24D-80U Input: 90-305VAC; Output: 24VDC (98605) GEPS12D-60U Input: 90-305VAC; Output: 12VDC (98615)    GEPS24-100U-GL Input: 108-305VAC; Output: 24VDC (98941) GEPS12-180U Input: 90-305VAC; Output: 12VDC (98609)    GEPS24-180U Input: 90-305VAC; Output: 24VDC (98602)
Maximum Supply Wire Limits	60W,80W, 100W,180W    20W    Supply Wire Gauge 20 ft. (6.1 m)    120 ft. (36.6 m)    18AWG/0.82mm <sup>2</sup> supply wire - 9409 25 ft. (7.6 m)    16AWG/1.31mm <sup>2</sup> supply wire 35 ft. (10.6 m)    14AWG/2.08mm <sup>2</sup> supply wire 40 ft. (12.1 m)    12AWG/3.31mm <sup>2</sup> supply wire <i>Wiring to be installed in accordance with Article 725 of the National Electric code (NEC).</i>
Operating Environment	-40 °C to +60 °C
Module Dimensions (h x l x w)	Tetra miniStrip & Tetra miniStrip High Output: 0.51 x 7.87 x 1.10 in. (13 x 200 x 28 mm)    Tetra miniStrip DS & Tetra miniStrip DS High Output: 0.59 x 7.87 x 1.10 in. (15 x 200 x 28 mm)
Sign Dimensions	For best results, recommended sign depth is 3 inches (76mm) or greater    For best results, recommended sign depth is 6 inches (152mm) or greater
Warranty	GE offers a limited system warranty of up to five (5) years
System Certifications	UL Recognized #E219167, UL Classified #E229508, CSA Approved #216319, CE, C-tick, IP66 rated: separate enclosure required, damp location rated



This product is intended solely for the use of non-residential signage lighting and is not intended for use in any other applications.

[www.gelighting.com/eu](http://www.gelighting.com/eu)

and General Electric are both registered trademarks of the General Electric Company

GE Lighting is constantly developing and improving its products. For this reason, all product descriptions in this brochure are intended as a general guide, and we may change specifications time to time in the interest of product development, without prior notification or public announcement. All descriptions in this publication present only general particulars of the goods to which they refer and shall not form part of any contract. Data in this guide has been obtained in controlled experimental conditions. However, GE Lighting cannot accept any liability arising from the reliance on such data to the extent permitted by law.

Tetra® miniStrip Brochure – August 2013